



The Maple | \$165,000 CAD

-  1 Bedroom
-  1 Bathroom
-  524 sq.ft. Interior

Introducing The Maple, our flagship model that exemplifies the art of small-space living. This thoughtfully designed 1-bedroom, 1-bathroom home spans 524 square feet, offering a harmonious blend of comfort, style, and functionality. Ideal for individuals or couples, The Maple is a true reflection of modern living without compromising on quality.

The Maple is not just a home; it's a lifestyle choice that embraces simplicity and comfort. Perfect for those looking to downsize, first-time homeowners, or anyone seeking a cozy retreat, this model demonstrates that a smaller footprint can still offer big possibilities. Experience the charm and functionality of The Maple, where every detail is designed to enhance your everyday living.

Unit Specifications

- Ground Level Single Floor Detached House
- 1 Bedroom | 1 Bathroom | 524 sq.ft. Living Space
- Smart Home Technology
- Ultra Energy Efficient Homes
- 20 Gauge Structural Steel
- Hardie Board Siding (Premium Metal Siding Optional Upgrade)
- Spray Foam Insulation
- Stainless Steel Appliances: (Refrigerator, Stove, DW, W/D)
- 9.5' Ceilings
- Heat Pump with Air Conditioning
- Electric Fireplace
- Electric Hot Water Heater
- Double Pane Vinyl Windows
- Vinyl Click Lock Flooring Throughout
- Aluminum & Glass Awning
- Open Concept Living
- Extra Storage Throughout
- LED Exterior Lighting

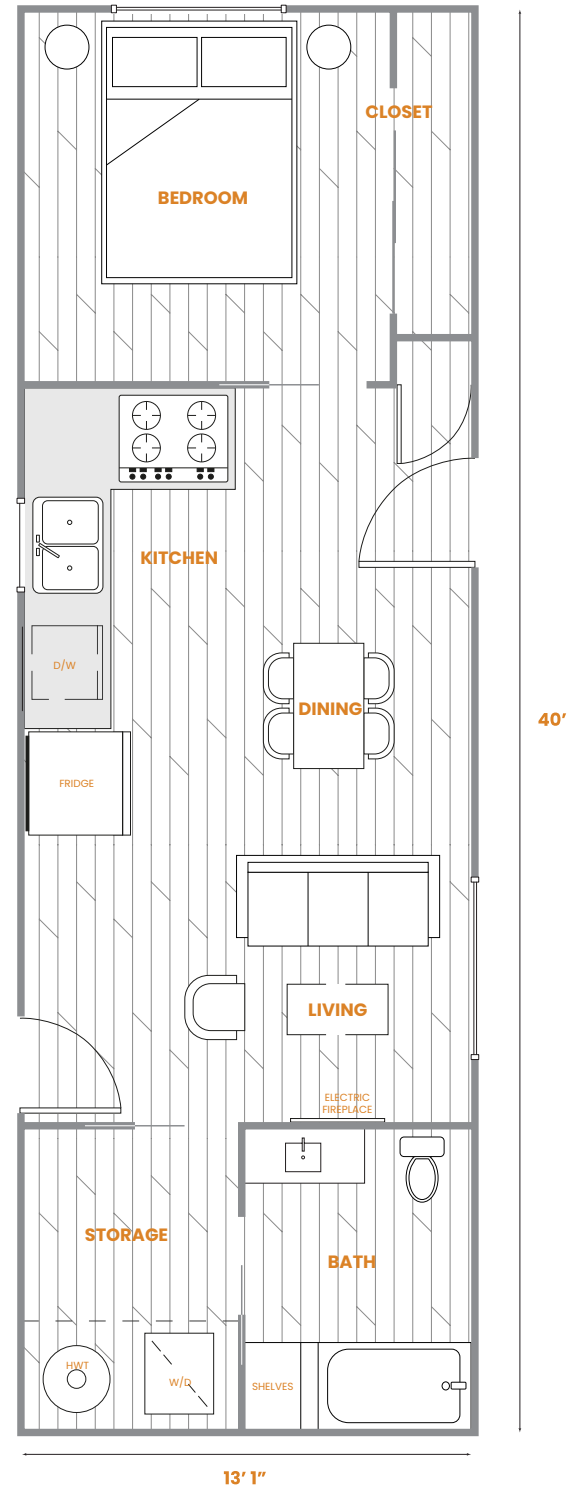

This is not an offering for sale. Prices, layouts, unit numbers/addresses, features and finishes, and internal and external areas are subject to change without notice. Floor plans may be oriented differently than displayed. Lane One Homes reserves the right to change floorplans, pricing, and materials without notice. Price does not include GST, transportation or installation costs.